

1 SECOND FLOOR DEMOLITION PLAN
 PD1.02 SCALE: 1/4" = 1'-0"

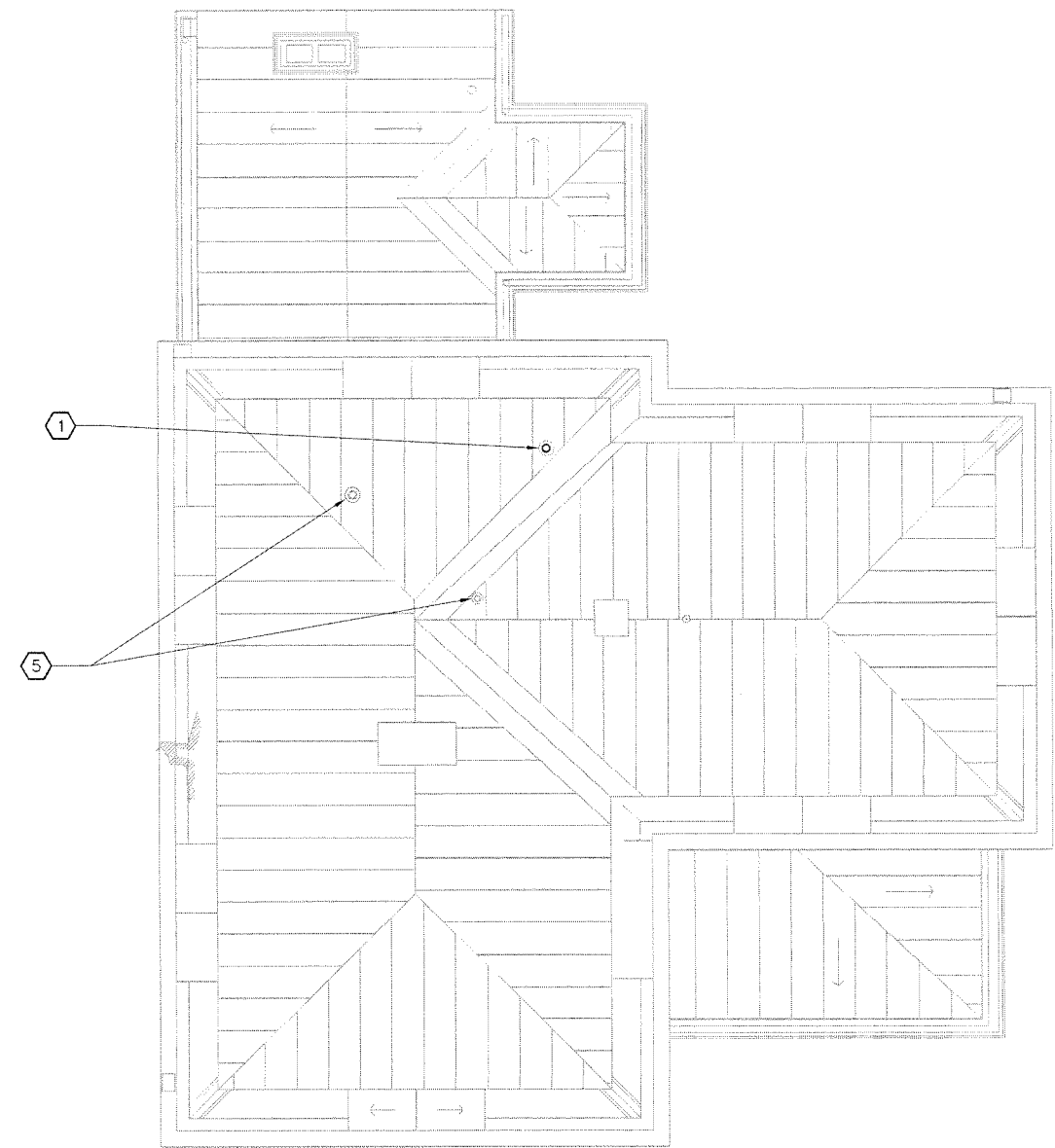

2 ROOF DEMOLITION PLAN
 PD1.02 SCALE: 1/4" = 1'-0"

KEYED NOTES

1. EXISTING VENT TERMINATION. INSPECT AND REPAIR WHERE POSSIBLE. REPLACE AS REQUIRED.
2. REMOVE EXISTING LAVATORY, ALL ASSOCIATED PIPING AND APPURTENANCES.
3. REMOVE EXISTING WATER CLOSET, ALL ASSOCIATED PIPING AND APPURTENANCES
4. REMOVE EXISTING BATHTUB/ SHOWER, ASSOCIATED PIPING AND APPURTENANCES.
5. CAP EXISTING VENT TERMINATION.

Plotted By: Julio Castillo | 4/27/09 | 3:58 PM



A/E FIRM
 PRIME/ARCH:
 BEYER BLINDER BELLE
 ARCHITECTS AND PLANNERS, LLP
 WASHINGTON, DC
 MEP ENG.:
 GHT CHARTERED
 ARLINGTON, VA

Mark	Sheet	REVISION	Date	Initial

PLUMBING DEMOLITION PLANS
 TITLE OF DRAWING

PD1.02
 SUB SHEET NUMBER

UNITED STATES
 DEPARTMENT OF THE INTERIOR
 NATIONAL PARK SERVICE - NATIONAL CAPITAL REGION
 BRANCH OF DESIGN AND CONSTRUCTION
 REHABILITATE DETERIORATED BATTLEGROUND NATIONAL
 CEMETERY SUPERINTENDENT'S LODGE AND ROSTRUM
 TITLE OF PROJECT
 6625 GEORGIA AVE NW, WASHINGTON, DC
 LOCATION WITHIN PARK
 ROCK CREEK PARK
 NAME OF PARK

DESIGNED	-
DRAWN	-
CHECKED	-
DWG. NO.	858
PROJECT NO.	8001G
DATE	APR. 24, 2009
SHEET	45 of 59

ARL: \\Project\2008\20814501\1\PLUMB-DEMO