

1 SECOND FLOOR DEMOLITION PLAN  
MD1.02 SCALE: 1/4" = 1'-0"

- # KEYED NOTES #
- EXISTING RADIATOR TO BE REMOVED (TYP.).
  - EXISTING BOILER FLUE TERMINATION TO REMAIN.
  - EXISTING WINDOW MOUNTED A/C UNIT TO BE REMOVED.

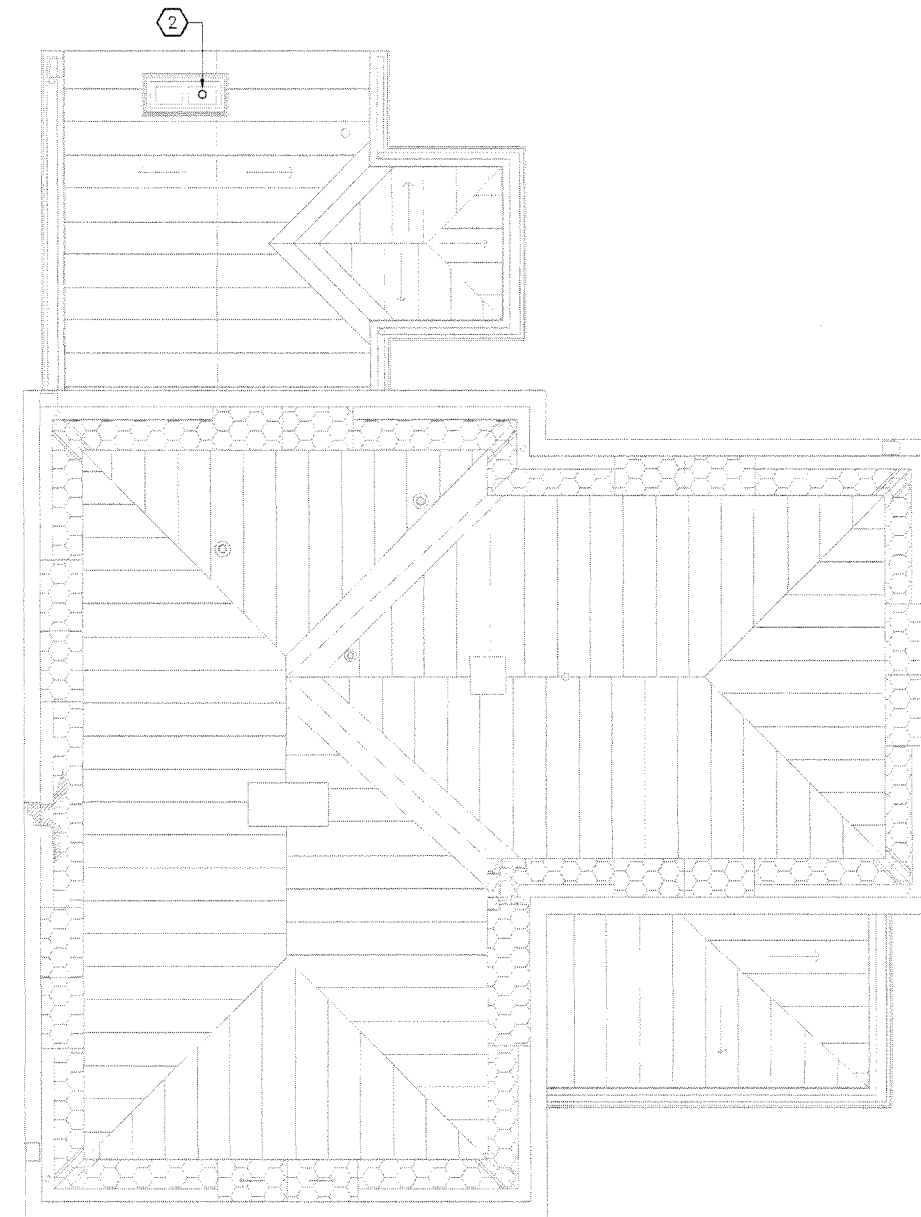

2 ROOF DEMOLITION PLAN  
MD1.02 SCALE: 1/4" = 1'-0"

Plotted By: Julio Castellano | 4/27/09 | 3:56 PM

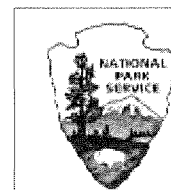

A/E FIRM  
PRIME/ARCH:  
BEYER BLINDER BELLE  
ARCHITECTS AND PLANNERS, LLP  
WASHINGTON, DC  
MEP ENG.:  
GHT CHARTERED  
ARLINGTON, VA

Mark	Sheet	REVISION	Date	Initial

MECHANICAL DEMOLITION PLANS  
TITLE OF DRAWING

MD1.02

SUB SHEET NUMBER

UNITED STATES  
DEPARTMENT OF THE INTERIOR  
NATIONAL PARK SERVICE - NATIONAL CAPITAL REGION  
BRANCH OF DESIGN AND CONSTRUCTION  
REHABILITATE DETERIORATED BATTLEGROUND NATIONAL  
CEMETERY SUPERINTENDENT'S LODGE AND ROSTRUM  
TITLE OF PROJECT  
6625 GEORGIA AVE NW, WASHINGTON, DC  
LOCATION WITHIN PARK  
ROCK CREEK PARK  
NAME OF PARK

DESIGNED	
DRAWN	
CHECKED	
DWG. NO.	858
PROJECT NO.	80010
DATE	APR. 24, 2009
SHEET	38 of 59

ARL:\Projects\2008\20081450\W-PLAN2-DEMO